

Technology pivot:  
Bottom and Back Panel Measurement  
16MM Density Panel

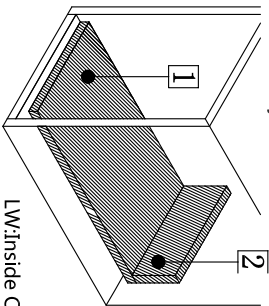

- 1 Bottom panel width=Inside Cabinet Width-75±0.5
- 2 Bottom panel length=Runner length-10MM
- Back panel height= 183MM
- Back panel width=Inside Cabinet Width-87±0.5

### Special Features:

- Length:270,300,350,400,450,500,550mm.
- The drawer side-board is 203mm high.
- Drawer width can be designed freely with automatic error adjustment.
- Hidden full pulout silencing sliding slid can bear 40kg and enjoys excellent stability and quiet and smooth sliding performance.
- Quick installation and dismantle.
- Newly-designed built-in damper is free from reinstallation and ensures soft and smooth drawer movements.

| Basic length | Internally usable drawer depth | Minimum installation depth of drawer | Minimum installation height |
|--------------|--------------------------------|--------------------------------------|-----------------------------|
| 300mm        | 274mm                          | 300mm                                | 225mm                       |
| 350mm        | 324mm                          | 350mm                                | 225mm                       |
| 400mm        | 374mm                          | 400mm                                | 225mm                       |
| 450mm        | 424mm                          | 450mm                                | 225mm                       |
| 500mm        | 474mm                          | 500mm                                | 225mm                       |
| 550mm        | 524mm                          | 550mm                                | 225mm                       |

### 1. Guide

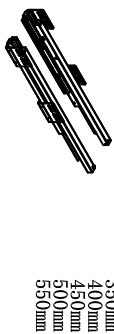

Left/Right Length : 300mm  
350mm  
400mm  
450mm  
500mm  
550mm

### 2.Drawer Side & Decorative Cap

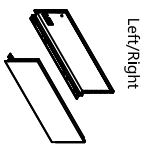

Left/Right Length:  
300mm  
350mm  
400mm  
450mm  
500mm  
550mm

### 3.Back connector



### 4.Front connector



### 5.Upper pin



### Runner Installation(mm)

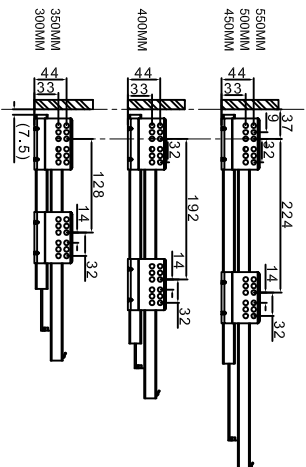

Basic length:300/350/400/450/500/550

### Inside Cabinet Dimension

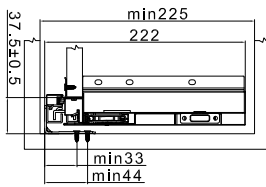

### Front Panel Mounting Positions

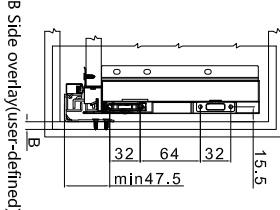

### Front Fixing Brackets Positions

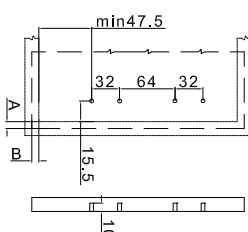

### Back Panel Mounting Positions

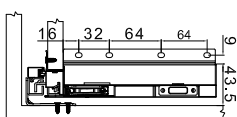

### Front fixing brackets mounting

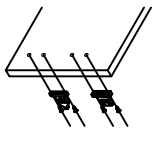

### B Side overlay(user-defined)

- 1 Tighten the fixing screw after installed the panel
- 2 Press the upper pin into panel after installed the panel

### A B Side overlay(user-defined)

- 1 Take out the back cover
- 2 Take out the upper pin

### Front panel height adjustment : ±2mm



### Front panel side adjustment : right/leftmm

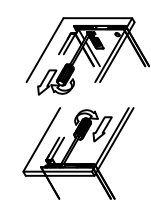

### Front panel side adjustment : left/rightmm

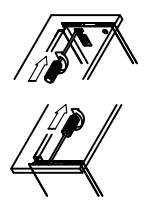

### Mounting the drawer

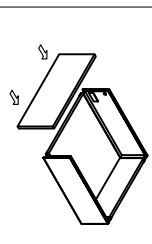
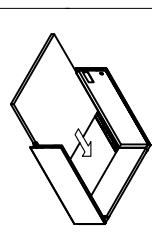
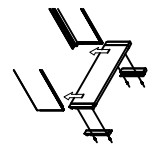

### Installing the drawer

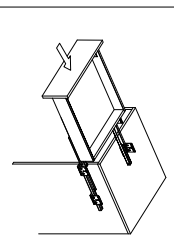
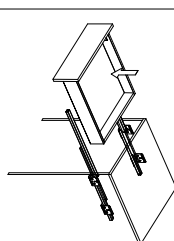
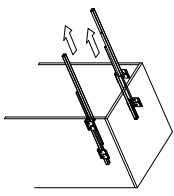

### Removing the drawer

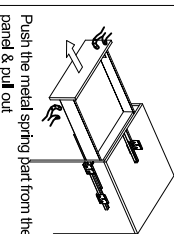

Push the metal spring part from the panel & pull out.

### Function of the damper

